

Contents

Important User Information	2	System Set Up	4
General	2	Decks	4
Manufacturer	2	Connecting Deck Assemblies	6
Intended Use	2	Stabilizer Brace Accessory	11
Warranty	2	Guardrail Accessory	13
Maintenance	2	Replacement Parts List	17
Decks	2	Rectangular Deck	17
Preventative Maintenance	2	Triangle Shaped Deck	18
Safety Precautions	2	Stabilizer Brace	18
Introduction	3	Straps and Connectors	19
Sizes	3	Fixed Height Leg	19
Accessories	3	Adjustable Height Leg	19
		Telescopic Leg	19
		Guardrail	20



Visit the Orchestra Pit Fillers and Stage Extensions web page at wengercorp.com for more information.

Note: Please read and understand these instructions before assembling or setting up.
Note: If you need additional information, contact Wenger Corporation using the information below.

Important User Information

General

Copyright © 2024 by Wenger Corporation

All rights reserved. No part of the contents of this manual may be reproduced, copied, or transmitted in any form or by any means including graphic, electronic, or mechanical methods or photocopying, recording, or information storage and retrieval systems without the written permission of the publisher, unless it is for the purchaser's personal use.

Printed and bound in the United States of America.

The information in this manual is subject to change without notice and does not represent a commitment on the part of Wenger Corporation. Wenger Corporation does not assume any responsibility for any errors that may appear in these instructions.

In no event will Wenger Corporation be liable for technical or editorial omissions made herein, nor for direct, indirect, special, incidental, or consequential damages resulting from the use or defect of these instructions. The manufacturer reserves the right to change this product at any time.

The information in this document is not intended to cover all possible conditions and situations that might occur. The end user must exercise caution and common sense when assembling or installing Wenger Corporation products. If any questions or problems arise, call the Wenger Corporation at (800) 4WENGER (493-6437) or +1-507-455-4100 worldwide.

Manufacturer

The StageTek® Staging System is manufactured by:

Wenger Corporation
555 Park Drive
Owatonna, MN 55060
(800) 4WENGER (493-6437) • +1 (507) 455-4100
wengercorp.com

Intended Use

- This product is designed to be a platform for performance groups.
- This product is intended for indoor use in normal ambient temperature and humidity conditions — it must not be exposed to prolonged outside weather conditions.
- This product is intended to be assembled only as described in these instructions.

Warranty

This product is guaranteed free of defects in materials and workmanship for five full years from date of shipment. A full warranty statement is available upon request.

Maintenance

Decks

Keep the deck surfaces clean and dry. When necessary, clean with a broom or brush. No other maintenance is required. Do not use oil-based cleaning products, and do not wax or polish the decks.

If painting or repainting the top surface is desired, consult local paint suppliers for recommendations. Prevent paint from entering cam locks and on edges of decks.

Preventative Maintenance

Inspect all hardware on the platform and accessories every six months, and tighten as necessary.

Replace any worn, bent, or broken parts promptly to prevent injury.

Safety Precautions

Throughout this document you may find cautions and warnings which are defined as follows:

- **WARNING:** Failure to follow the instruction could result in serious injury or damage to property.
- **CAUTION:** Failure to follow the instruction could result in minor injury or damage to property.

Read all of these safety instructions before using the equipment.

CAUTION

Make sure anyone assembling or installing the StageTek Pit Filler or Stage Extension System has read and understands these instructions.

CAUTION

Failure to comply with Warnings and Cautions in this document can result in damage to property or serious injury.

CAUTION

Always observe and comply with the Warnings and Cautions posted on the system equipment.

CAUTION

Take measures to protect deck surface from damage.

CAUTION

Consult local building/fire officials for code compliance.

WARNING

Use of some man lifts is prohibited. Please contact Wenger Corporation Customer Service for written certification of the man lift intended to be used. Be prepared to provide make and model for consideration.

WARNING

Take precautions to safe guard opening(s) when platforms are not in-place.

Introduction

Sizes

The StageTek Pit Filler or Stage Extension System has been custom designed for your application. Decks will vary in shape and size.

Accessories

Available accessories include:

- Center Leg Kit
- Closure Panels
- Connection Brackets
- Guardrails
- Horizontal Storage Cart
- Pit and Edge Safety Nets
- Leg Retention Clips
- Stabilizer Braces
- Universal Deck & Rail Cart
- Stairways
- Ramps

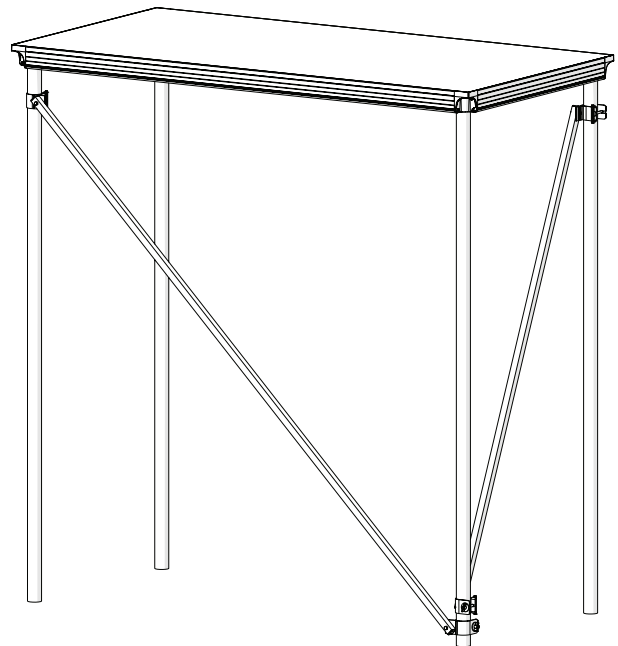

StageTek Rectangular Deck shown with Optional Bracing (depending on application)

System Set Up

Decks

1. Move the platform decks to the set up area.

The universal move & store cart is available to transport up to six StageTek rectangular decks (without accessories attached) or six StageTek guardrails. The carts make set up and tear down more efficient and help prevent handling damage.

The cart will fit through a standard 32" (813 mm) doorway.

CAUTION
Two people are recommended to lift the platform decks.

CAUTION
Platform decks can tip over if stored on their side without using a universal deck & store cart.

CAUTION
Secure load to cart with provided ratchet strap when moving carts.

The Universal Deck & Rail Cart is not recommended to be used on gravel, grass, or soft ground

Universal Deck & Rail Cart Loaded with six Rectangular Decks

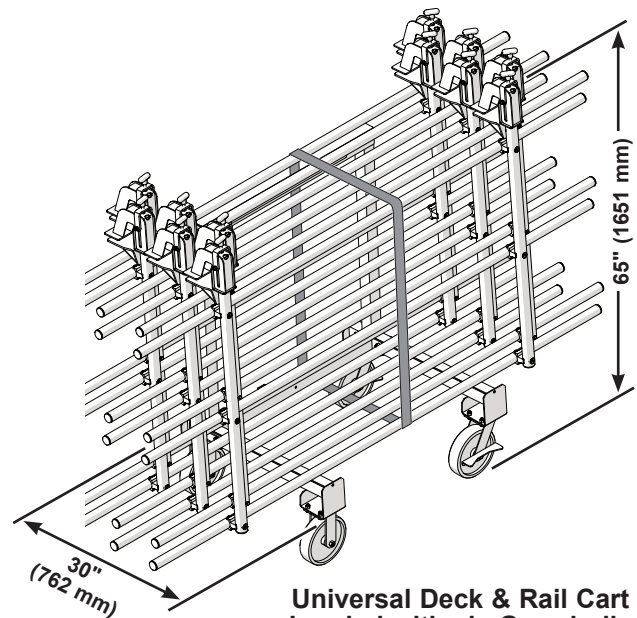
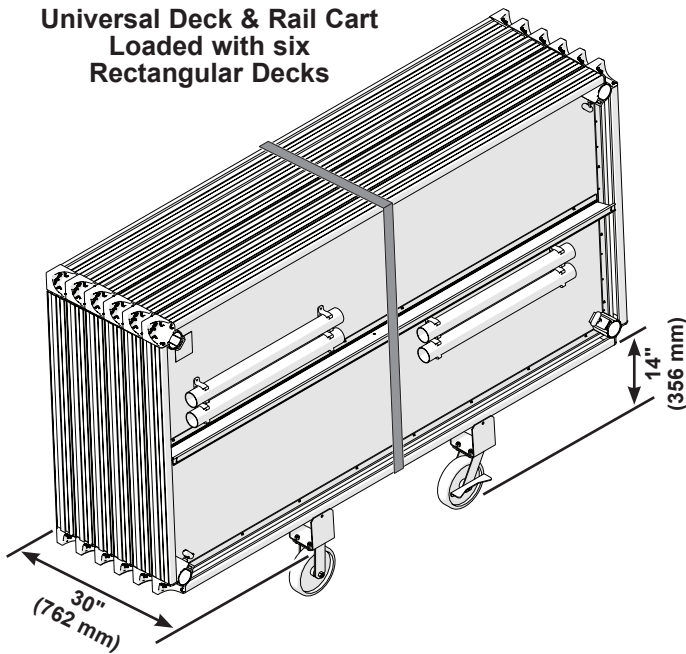

Universal Deck & Rail Cart Loaded with six Guardrails

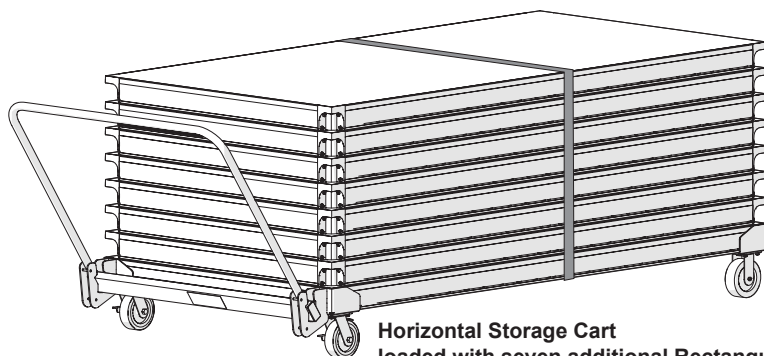

Horizontal Storage Cart loaded with seven additional Rectangular Decks

System Set Up (continued)

Decks (continued)

2. Typical leg attachment procedure.
 - a. Insert the legs all of the way into each of the pocket assemblies.
 - b. Secure each leg by hand tightening the knob on every pocket assembly.
No tools are required.

NOTICE

Handle decks carefully to prevent damage to edges.

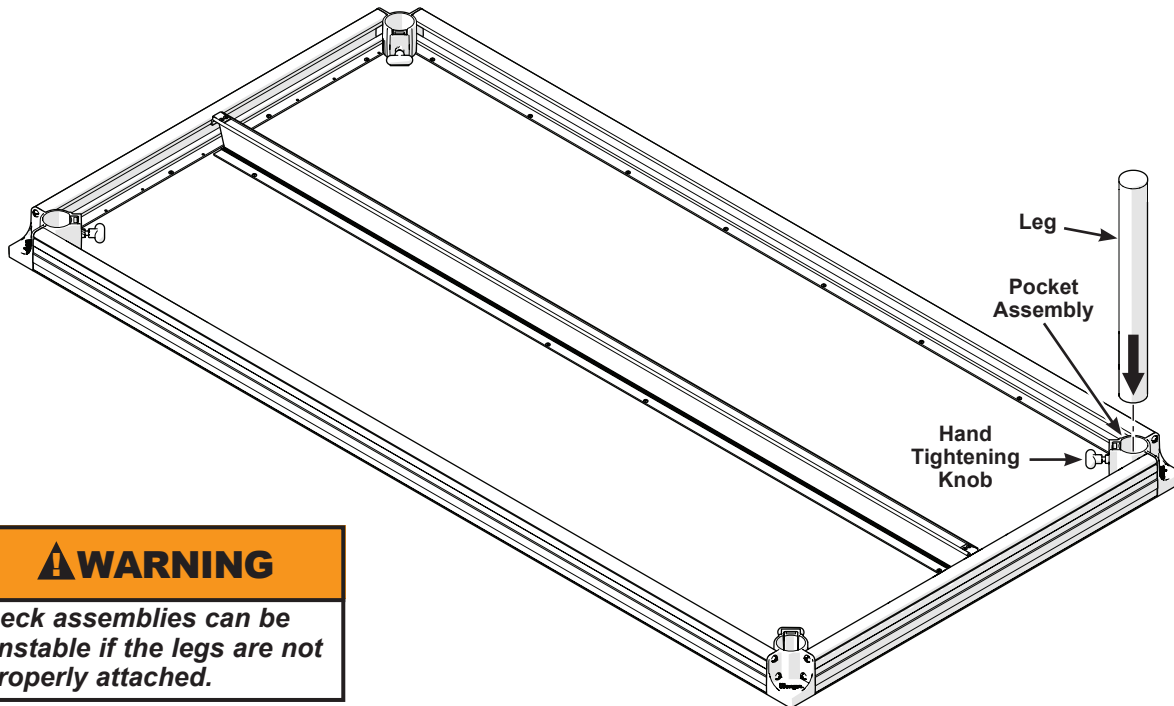

⚠ WARNING

Deck assemblies can be unstable if the legs are not properly attached.

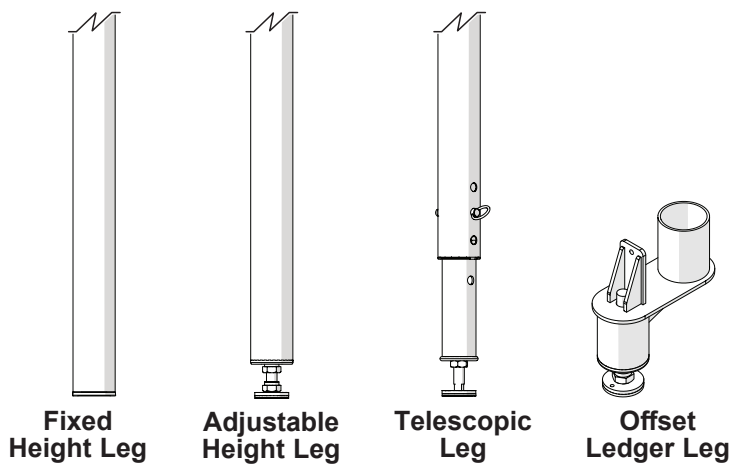

System Set Up (continued)

Connecting Deck Assemblies

1. Position the center deck in the pit opening or located appropriately for the stage extension and attach the legs provided.

NOTICE

If adjustable height legs or telescopic legs are used, adjust them to the required length and tighten the jam nuts.

2. Set one adjacent deck against the center deck and attach the legs provided. Engage the cam lock(s) to secure the decks together using the supplied hex allen wrench and rotating clockwise until the cam is engaged and the decks are drawn together tightly. Observe male/female orientation of cam locks or deck number as shown on plan view and bottom of each deck.
3. Continue placing decks by working toward each side, alternating between stage left and right, repeating Step 2 until all decks are in place.
4. Refer to the project specific submittal drawing and install leg connectors, anchors, or ledger foot clamps as shown.
5. Refer to the project specific submittal drawing and install any other accessories such as stabilizers and guard rails as shown prior to using the pit filler.

WARNING

The stage system is unstable unless all adjoining deck assemblies are connected and the decks are anchored to a permanent structure such as the stage front or audience wall.



= Cam Lock (installed in deck sides)



= Two Leg Rectangular Deck Connector



= Two Leg Pie Deck Connector

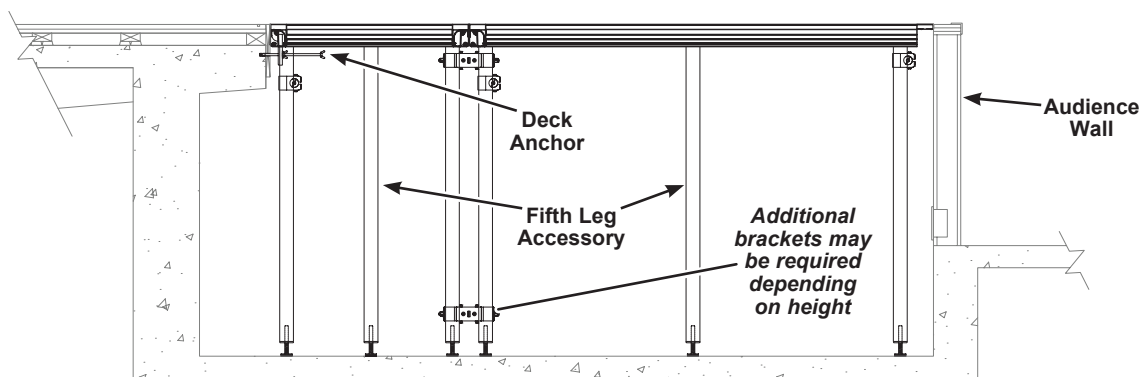
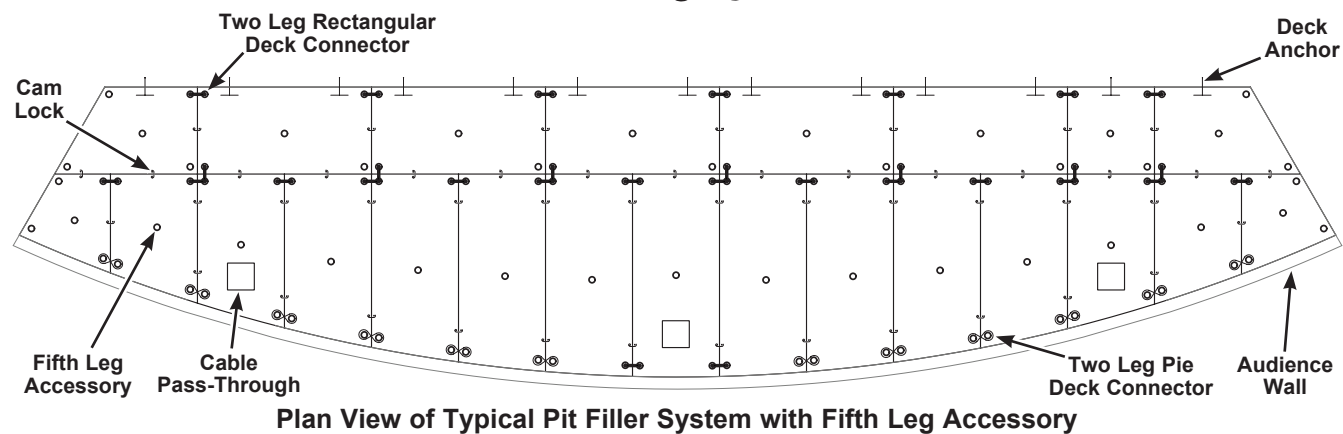

System Set Up (continued)

Connecting Deck Assemblies (continued)

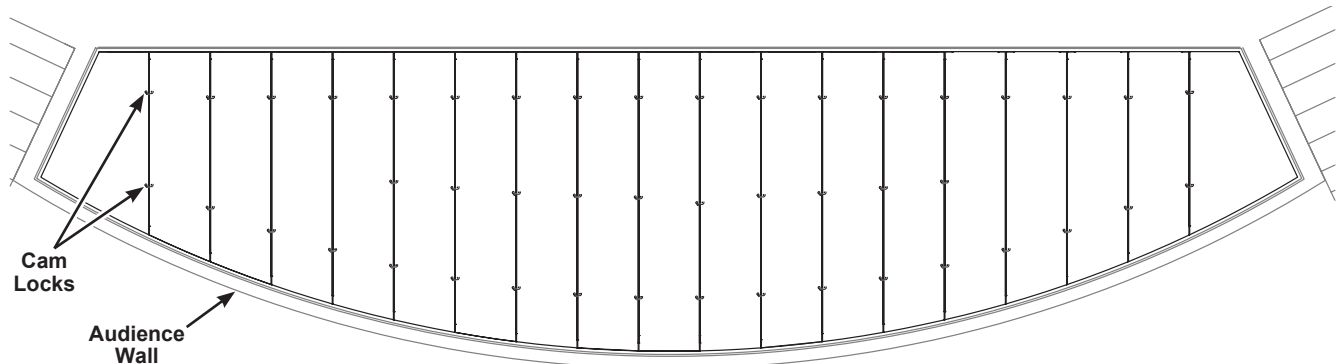

Plan View of Typical Pit Filler System on Ledger Angles

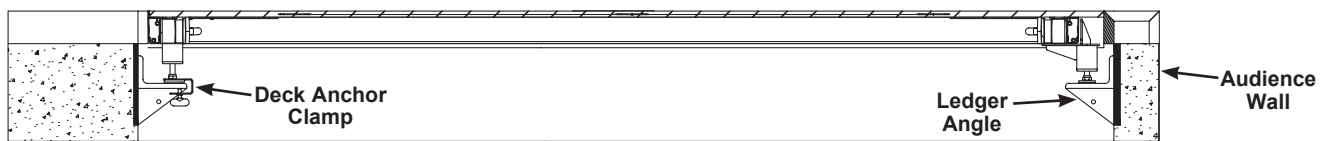

Elevation View of Typical Pit Filler System on Ledger Angles

System Set Up (continued)

Connecting Deck Assemblies (continued)

Cam Lock Operation

Secure adjacent deck frames together by engaging the cam locks. Insert a cam lock wrench into the hole in the deck surface and turn it clockwise to engage the cam lock and draw the decks together tightly.

Turn counter-clockwise to disengage the cam locks.

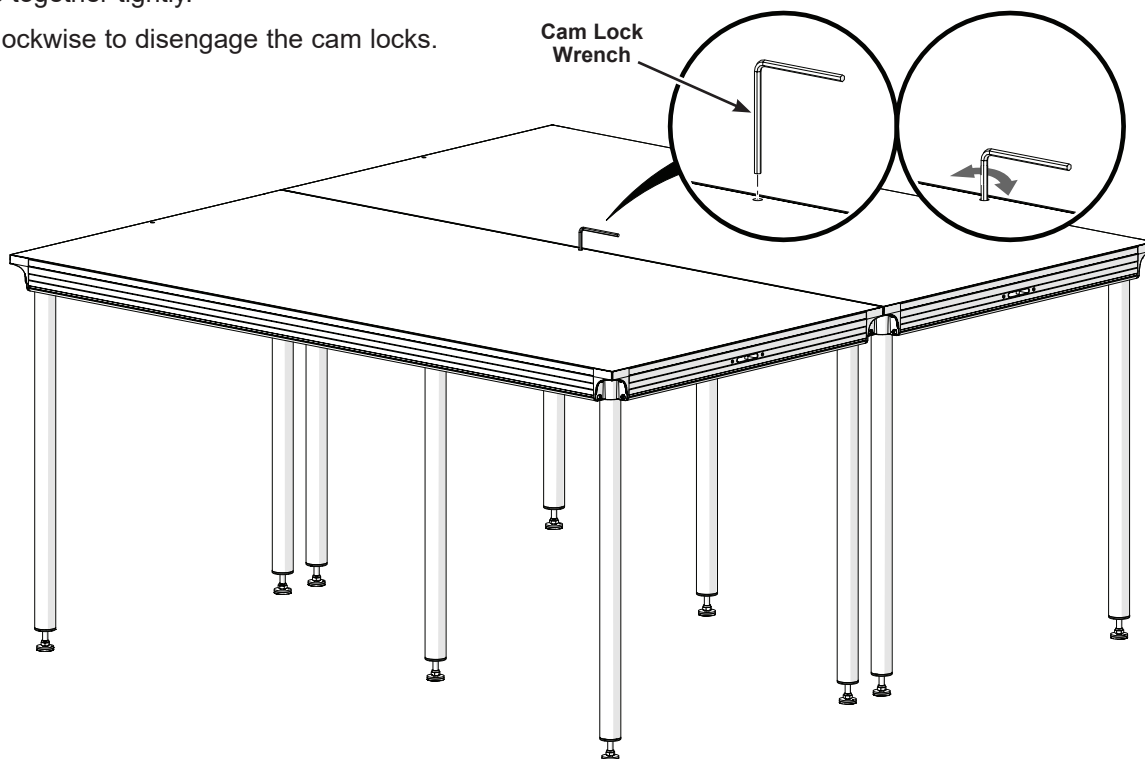

T-Handle Lifting Devices

To lift decks using the supplied t-handle devices, carefully thread the t-handle into the female threaded insert (minimum of four turns of engagement) in the corners of the lift-out deck. Using a minimum of two people, lift the deck up and out.

Reverse the procedure to install the deck using the t-handles.

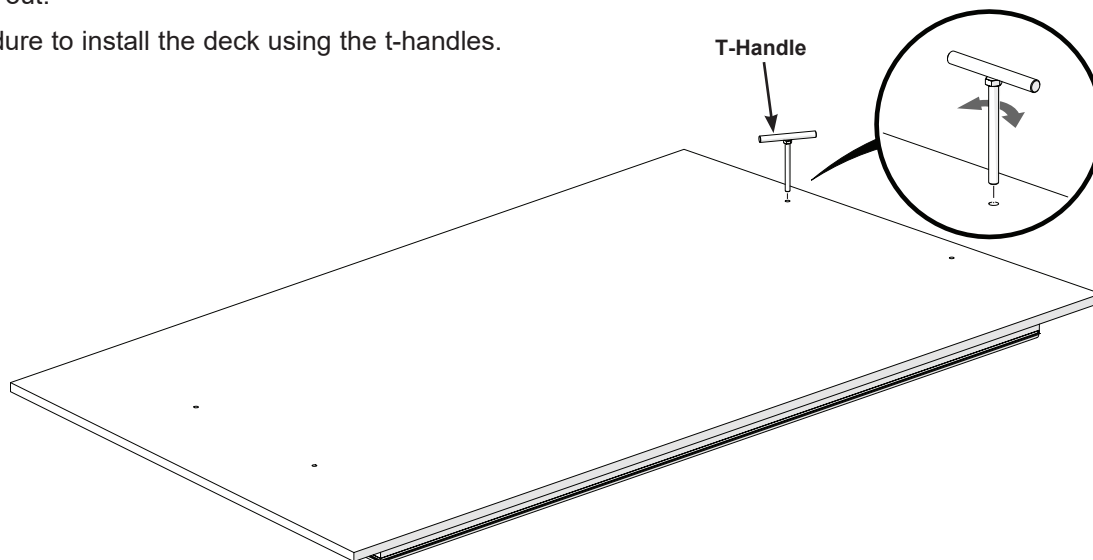

System Set Up (continued)

Connecting Deck Assemblies (continued) Straps and Connectors

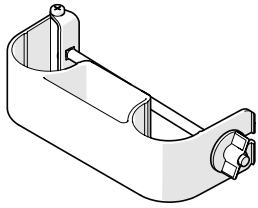

Two Leg Rectangular Deck Connector

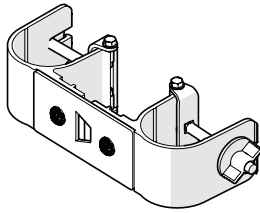

Two Leg Pie Deck Connector

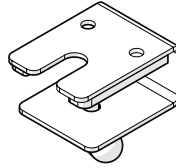

Ledger Foot Clamp

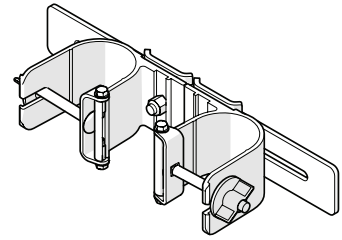

Two Leg Adjustable Connector

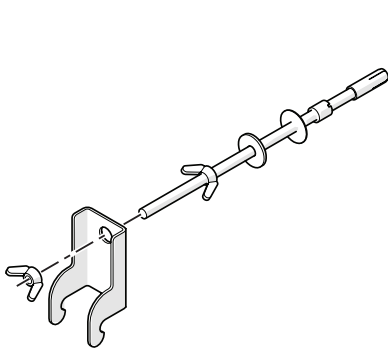

Short Frame Deck Anchor

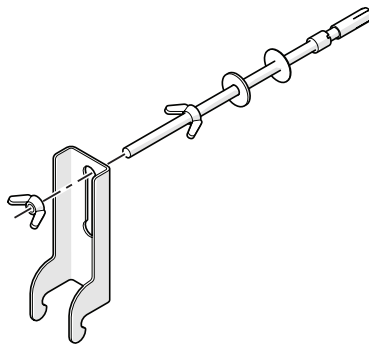

Long Frame Deck Anchor

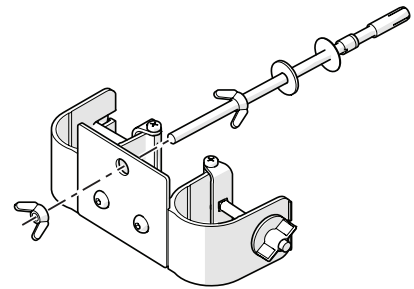

Leg Deck Anchor

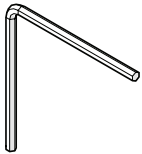

Cam Lock Wrench

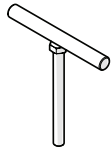

T-Handle

System Set Up (continued)

Connecting Deck Assemblies (continued)

To Attach Connectors

1. For best stability, attach the connector as high up on the leg as possible.
2. With the flat side facing out, fit the connector over both legs.
3. Attach the connector to each leg by closing the bolt and securing with a wing nut.

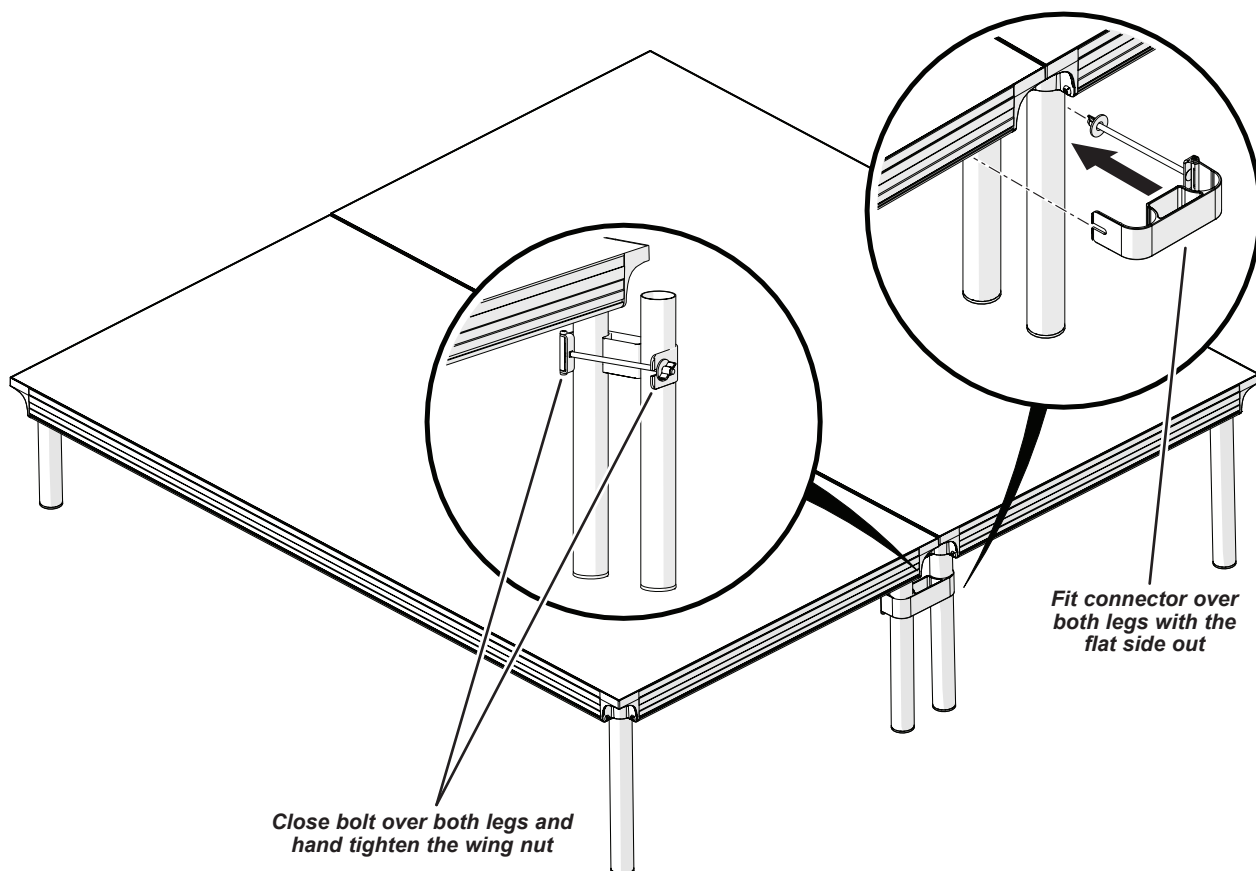

System Set Up (continued)

Stabilizer Brace Accessory

CAUTION

Stabilizer braces longer than 96" (2438 mm) must be used as an "X" brace.

Assembly

1. Refer to the project specific submittal drawing and install stabilizer braces as shown.
2. Attach a leg clamp assembly to each end of the stabilizer tube using a 3/8-16 x 1.75" capscrew and 3/8-16 lock nut as shown.
3. Tighten the capscrew enough that the leg clamp assembly is secure, but may be rotated.

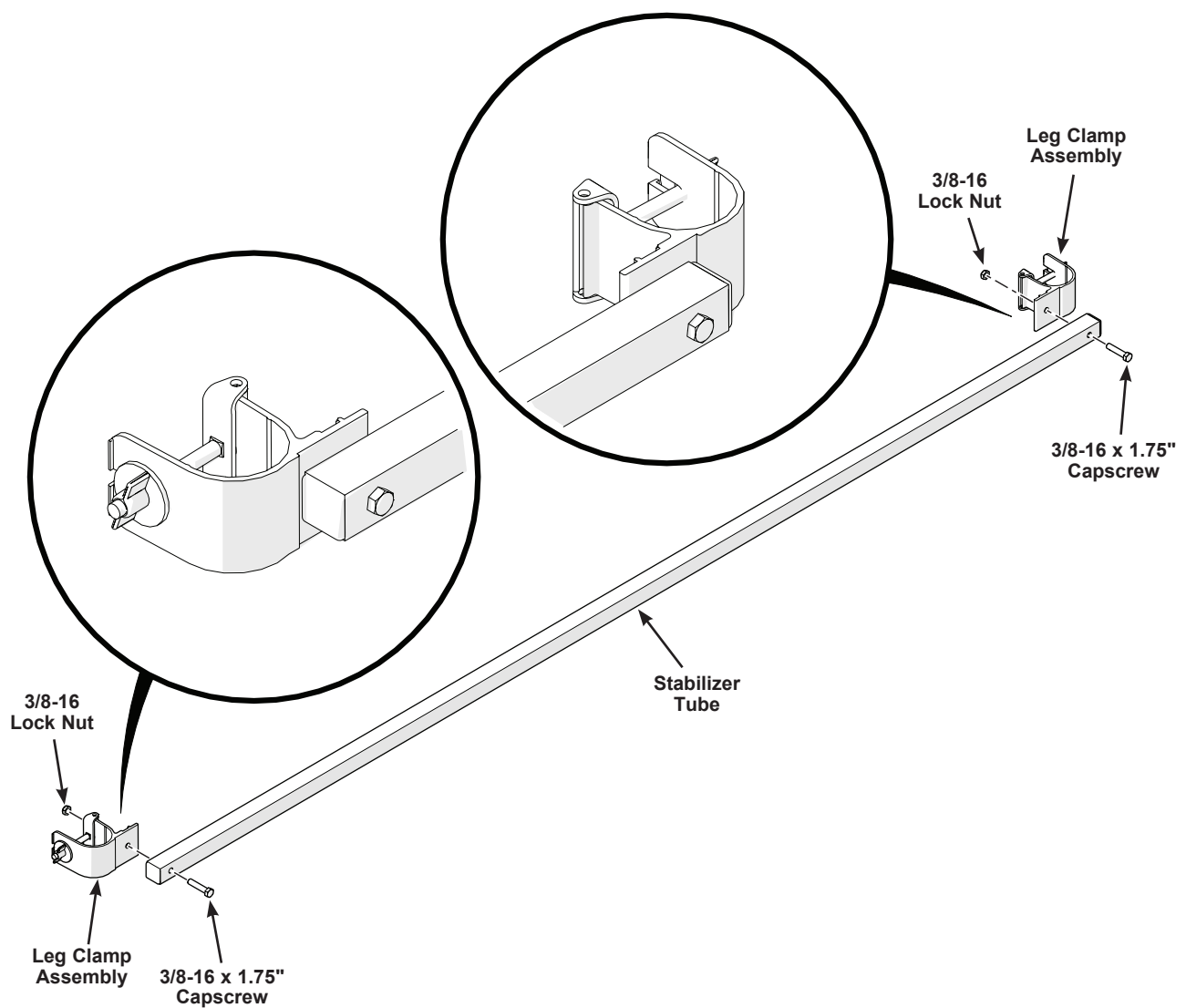

System Set Up (continued)

Stabilizer Brace Accessory (continued)

Operation

To attach the stabilizer brace to the stage deck:

1. Loosen the wing nuts from both leg clamp assemblies and swing them open.
2. Place the leg clamp assemblies onto the legs at opposite ends of the stage deck.
 - a. One end should be down toward the ground and the other end should be up toward the stage deck. Place clamps as close to the top and the bottom of legs as possible for the highest rigidity.
 - b. The space between the leg clamp assembly and the ground should be approximately the same as the space between the leg clamp assembly and the bottom of the stage deck on the opposite side.
3. Swing both leg clamp assemblies closed and tighten the wing nuts.

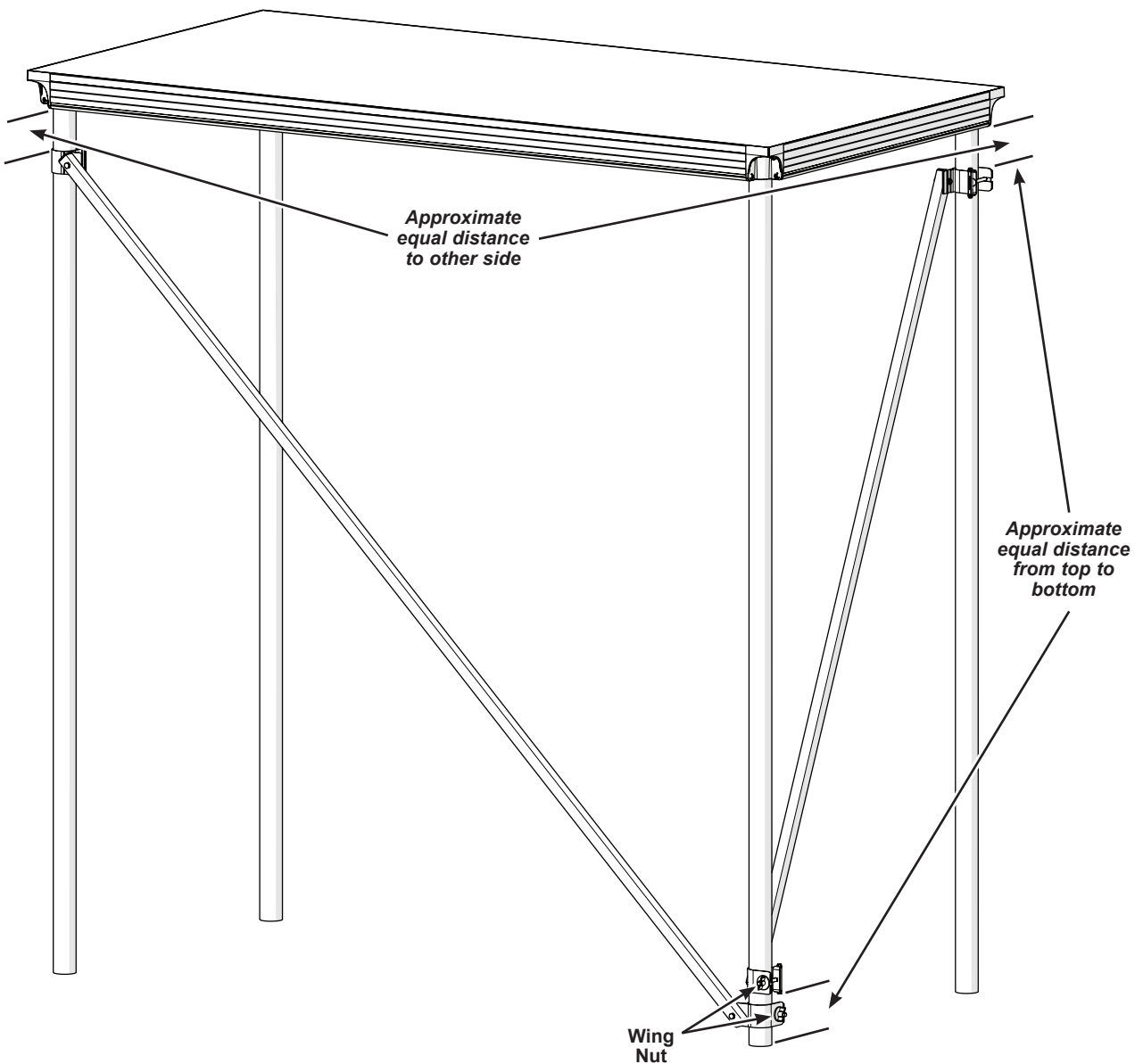

System Set Up (continued)

Guardrail Accessory

CAUTION

Guardrails are recommended for instances where the deck height is 12" (305 mm) or more.

Assembly Without Optional Infill Panels

To assemble the guardrail without the optional infill panels:

Attach rails to the top, middle and bottom positions of both upright weldments using 3/8-16 x 3" carriage bolts, guardrail tube saddles, 1/2" ID toothed lock washers and 3/8-16 hex cap nuts as shown.

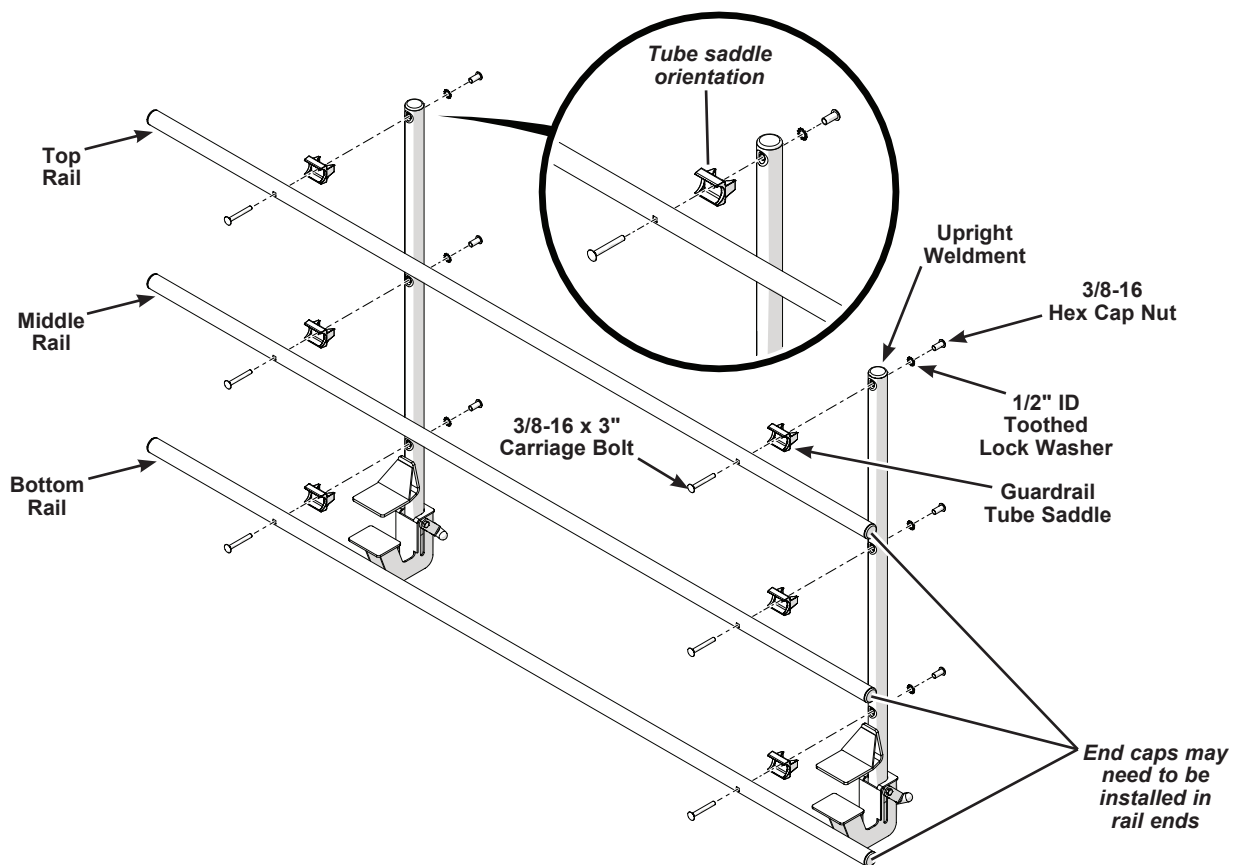

System Set Up (continued)

Guardrail Accessory (continued) Assembly With Optional Infill Panels

To assemble the guardrail with the optional infill panels:

1. Attach a rail to both the top and bottom positions of both upright weldments using 3/8-16 x 3" carriage bolts, guardrail tube saddles, 1/2" ID toothed lock washers and 3/8-16 hex cap nuts as described on the previous page.
Do not attach the middle rail yet!
2. With the vertical wires facing outward, center an infill panel to fit into the channel of both attached guardrail tube saddles behind both the top and bottom rails.
3. Place a guardrail tube saddle between the top and bottom infill panels at both ends to align with the middle pilot hole in the upright weldments.
4. Push the guardrail tube saddles and infill panels inward to be flush with the upright weldments.

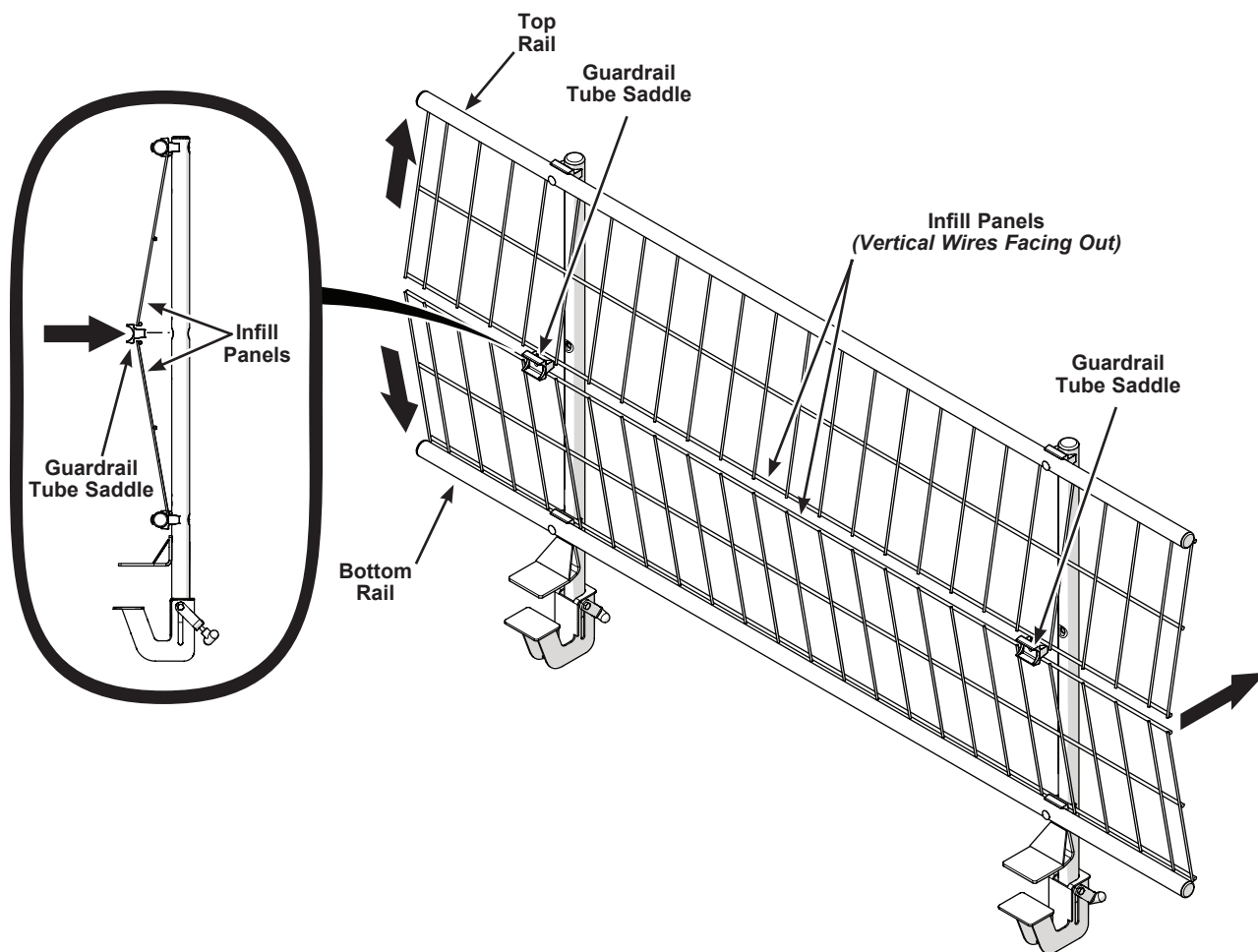

System Set Up (continued)

Guardrail Accessory (continued)

Assembly With Optional Infill Panels (continued)

5. Attach the middle rail to both upright weldments using a 3/8-16 x 3" carriage bolt through the guardrail tube saddle, 1/2" ID toothed lock washer and 3/8-16 hex cap nut on each end as previously described.

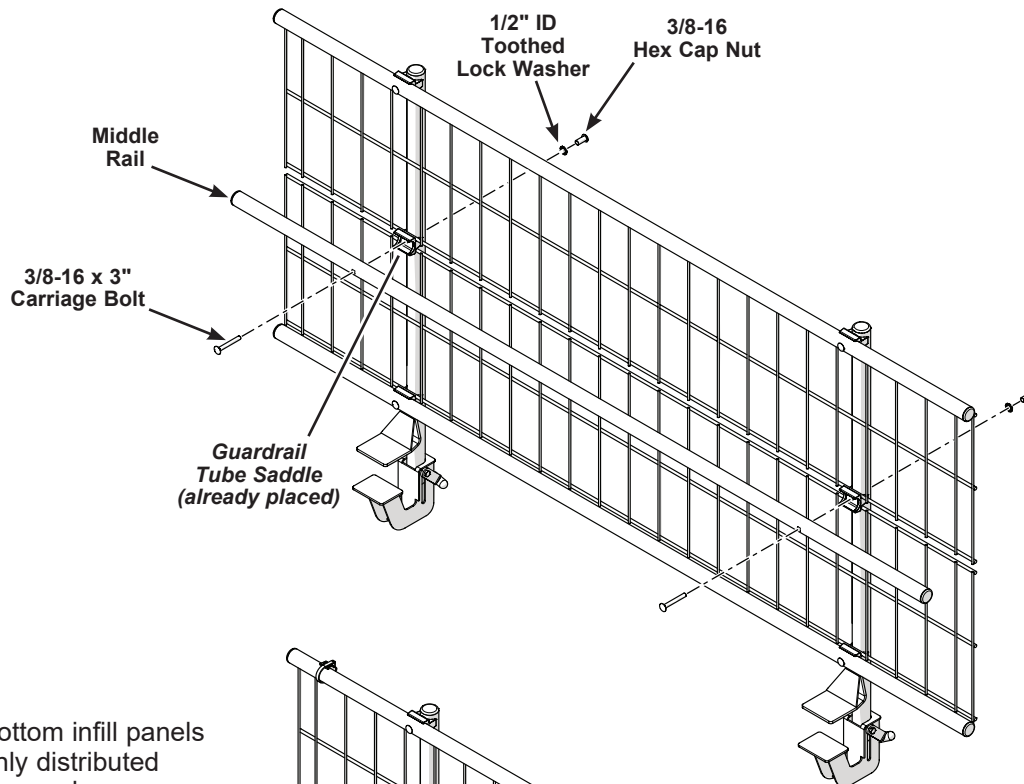

6. Secure the top and bottom infill panels to the rails using evenly distributed spacers and nylon ties as shown.
- Orient the nylon tie with the head towards the bottom of the assembly.
 - After the nylon tie has been tightened, trim off any excess to be flush with the head.

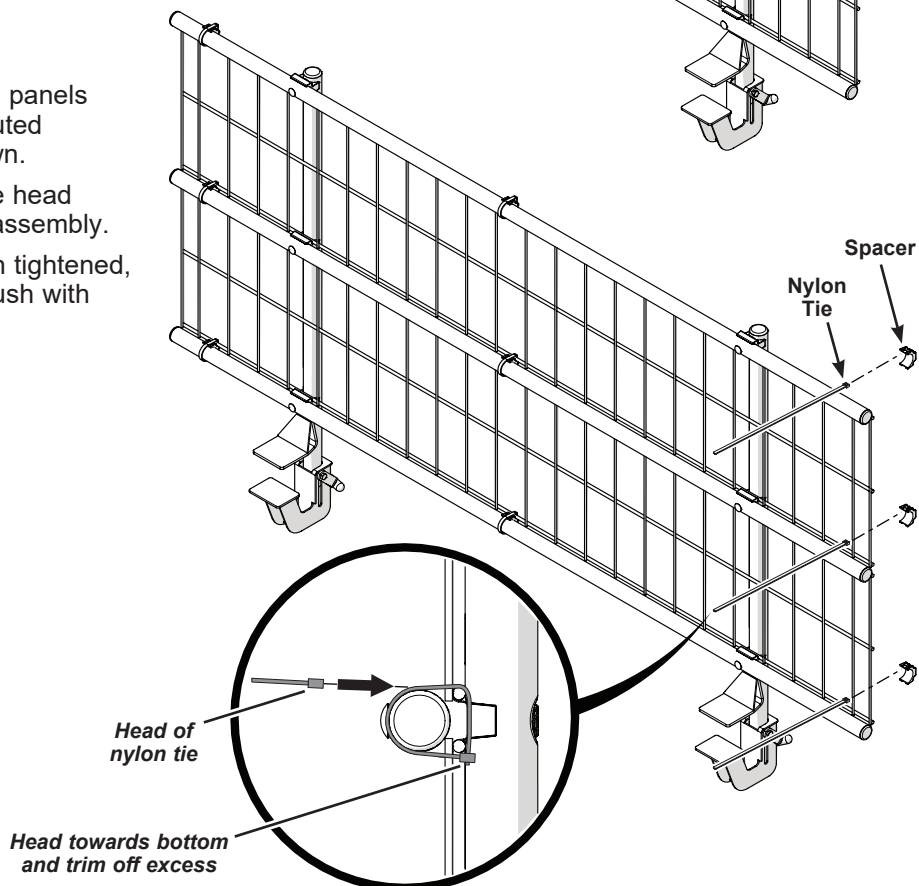

System Set Up (continued)

Guardrail Accessory (continued) Operation

To attach the guardrail to the stage deck:

1. Be sure that the lower slide at the base of both upright weldments are in the open position.

To move the lower slide to the open position:

- a. Loosen the knob.
- b. Rotate the pivot lock back from the lower slide.
- c. Move the lower slide down to the open position.

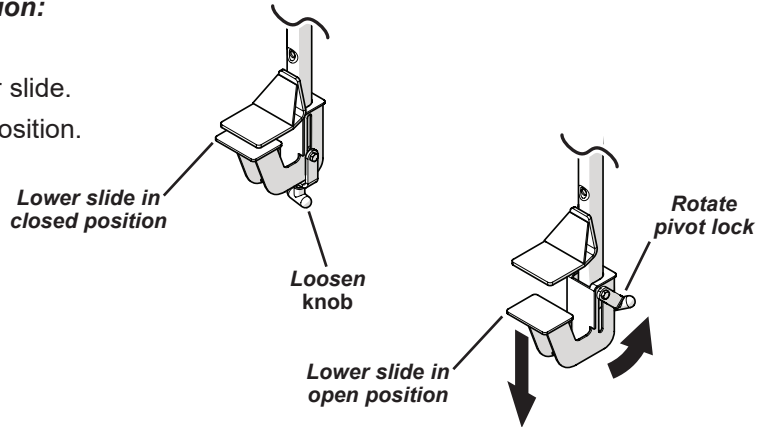

2. Using two people, lift the guardrail assembly to rest on the stage deck as shown. The lower slides should fit under the edge of the stage deck and be tight against the bottom of the stage deck when in the closed position.

4" (102 mm)
Maximum Gap

CAUTION
Two people are required to lift the guardrail assembly onto the stage deck.

3. Move the lower slides to the closed position:
 - a. Move the lower slide up to the closed position.
 - b. Rotate the pivot lock over the lower slide.
 - c. Tighten the knob.

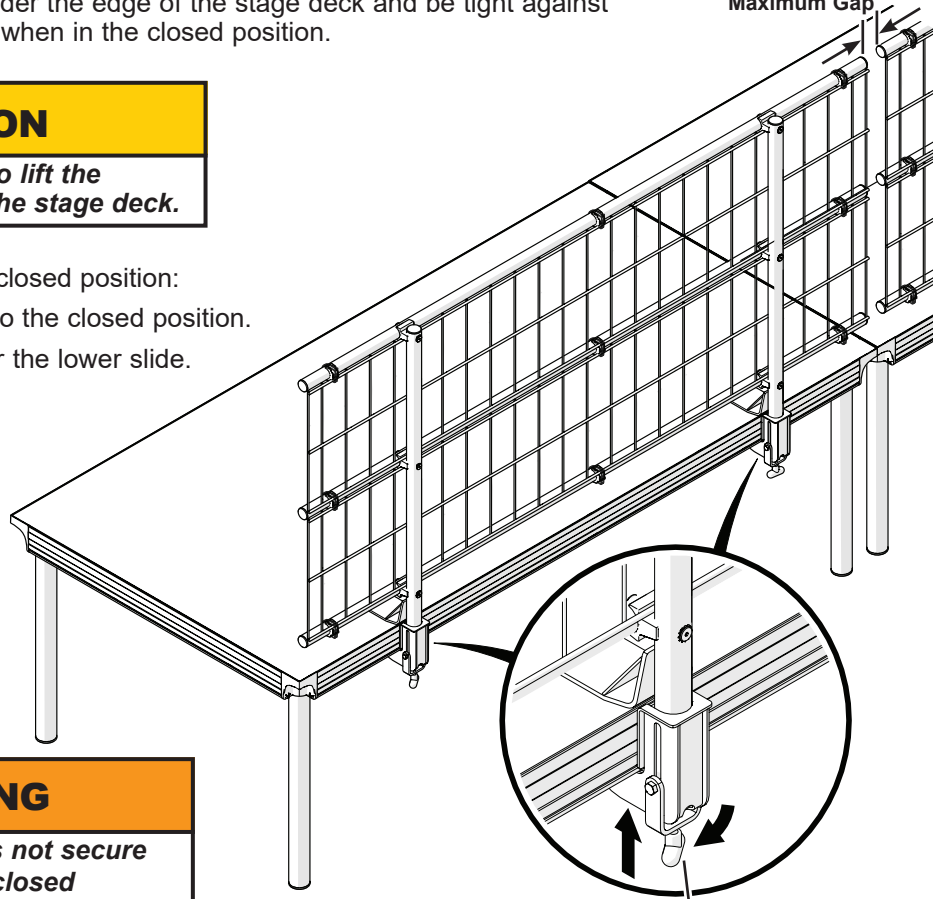

WARNING
The guardrail assembly is not secure until it is locked into the closed position on the stage deck as specified.

If multiple guardrail assemblies with optional infill panels are being attached, the gap between them can be no more than 4" (102 mm) apart as shown.

Return to closed position

Replacement Part List

Rectangular Deck

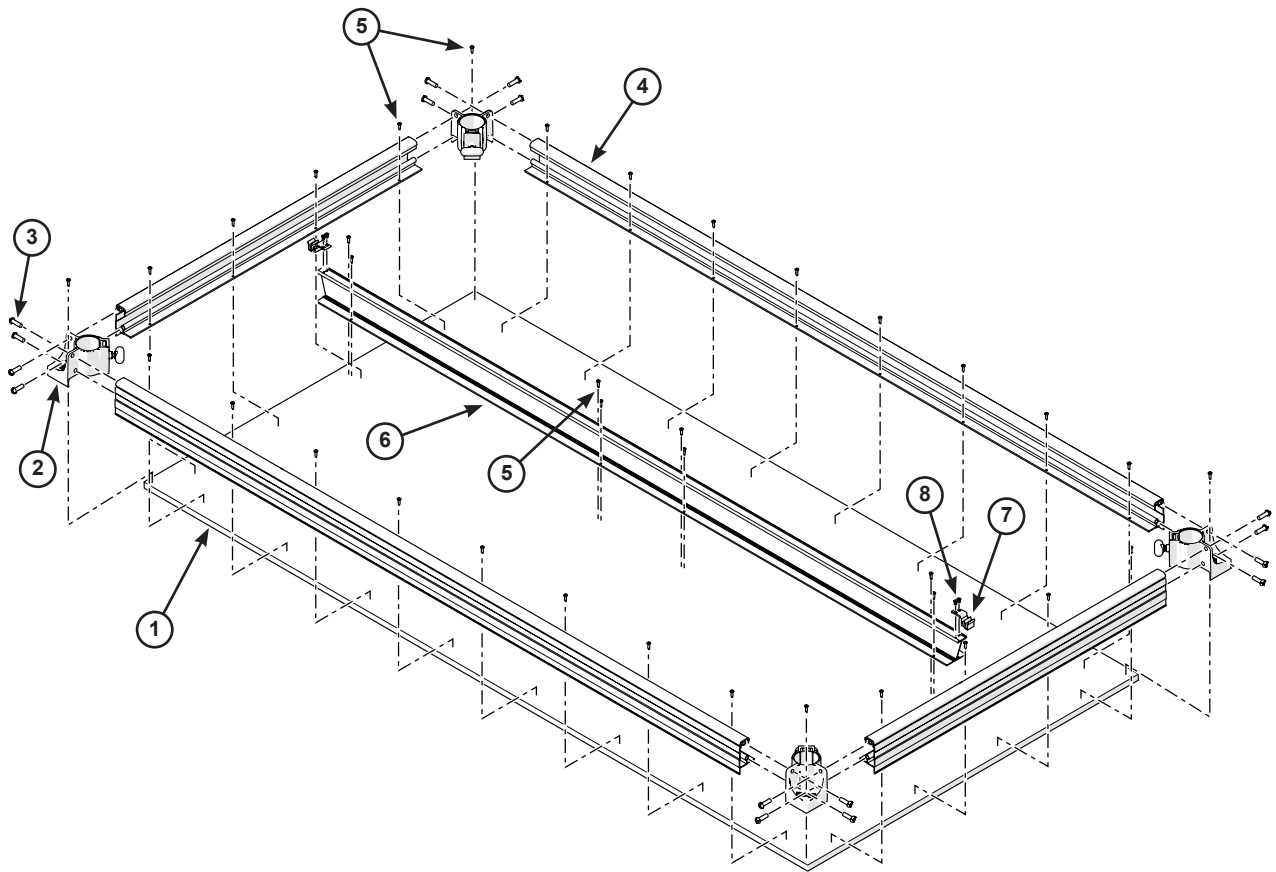

Item	Description	Item	Description
1	Deck Surface	5	Pan Head Screw, #10-16 x 3/4"
2	90° Corner Pocket Assembly	6	Mid Rail Brace
3	Torque Screw, 3/8-16 x 1-1/4"	7	Mid Rail Connect Extrusion
4	Deck Frame Extrusion	8	3/16" Blind Rivet

Replacement Part List (continued)

Triangle Shaped Deck

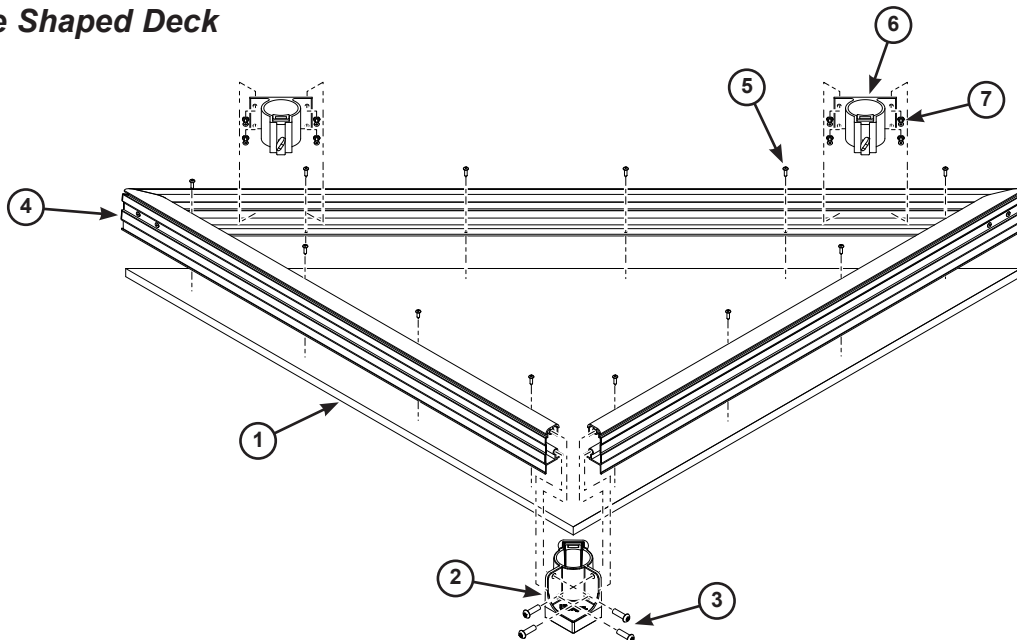

Item	Description	Item	Description
1	Deck Surface	5	Pan Head Screw, #10-16 x 3/4"
2	90° Corner Pocket Assembly	6	Straight Pocket Assembly
3	Torque Screw, 3/8-16 x 1-1/4"	7	1/4" Blind Rivet
4	Deck Frame Extrusion		

Stabilizer Brace

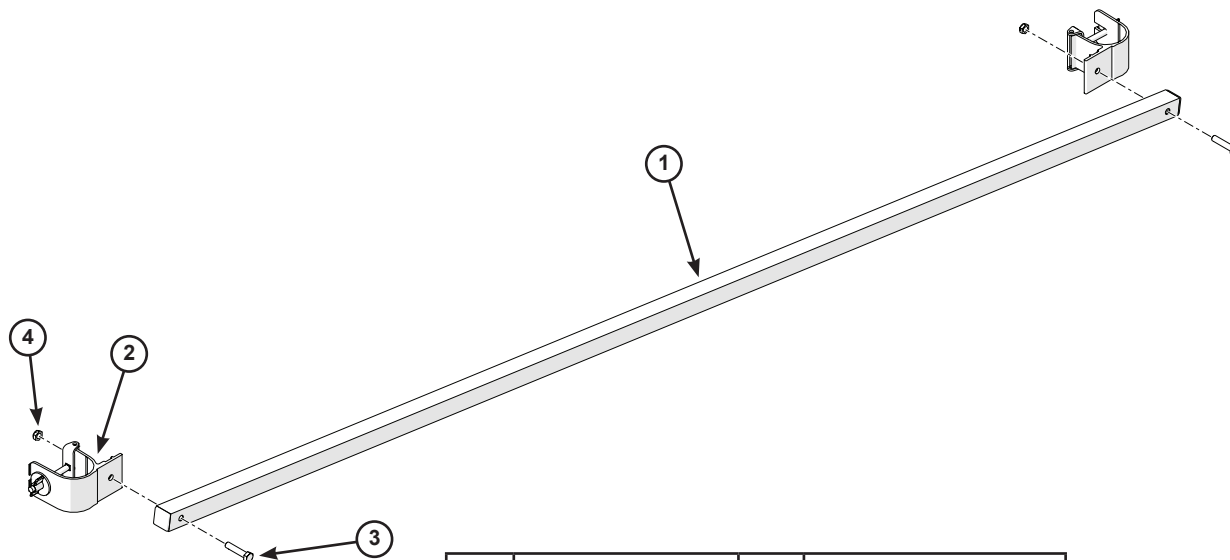

Item	Description	Item	Description
1	Stabilizer Tube	3	Capscrew, 3/8-16 x 1.75"
2	Leg Clamp Assembly	4	Lock Nut, 3/8-16

Replacement Part List (continued)

Straps and Connectors

Refer to Straps and Connectors on page 9.

Fixed Height Leg

Various heights available

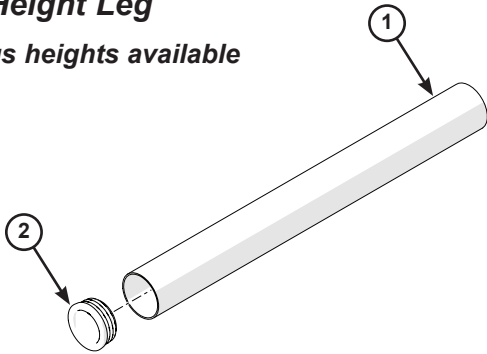

Item	Description
1	Aluminum Extrusion
2	Plug, 2-1/2" OD x 1/4-20 Gauge

Adjustable Height Leg

Various heights available

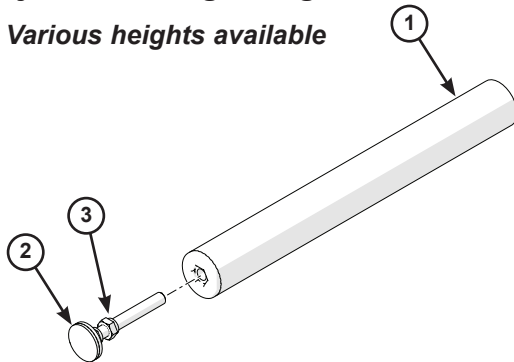

Item	Description
1	Leg Assembly
2	Adjustable Foot
3	Nut, Jam, Std Hex, ZP, 5/8-11

Telescopic Leg

Available in the following heights:

- 16" - 28" (406-711 mm)
- 24" - 40" (610-1016 mm)
- 30" - 54" (762 - 1372 mm)

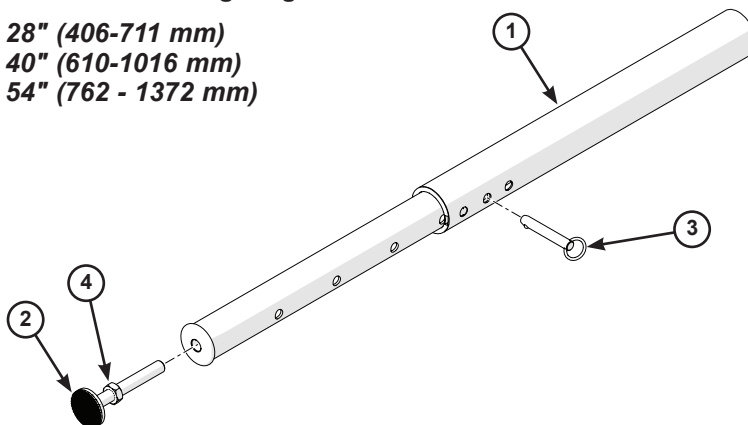

Item	Description
1	Leg Assembly
2	Adjustable Foot
3	Clevis Pin, 1/2" x 2-1/2"
4	Nut, Jam, Std Hex, ZP, 5/8-11

Replacement Part List (continued)

Guardrail

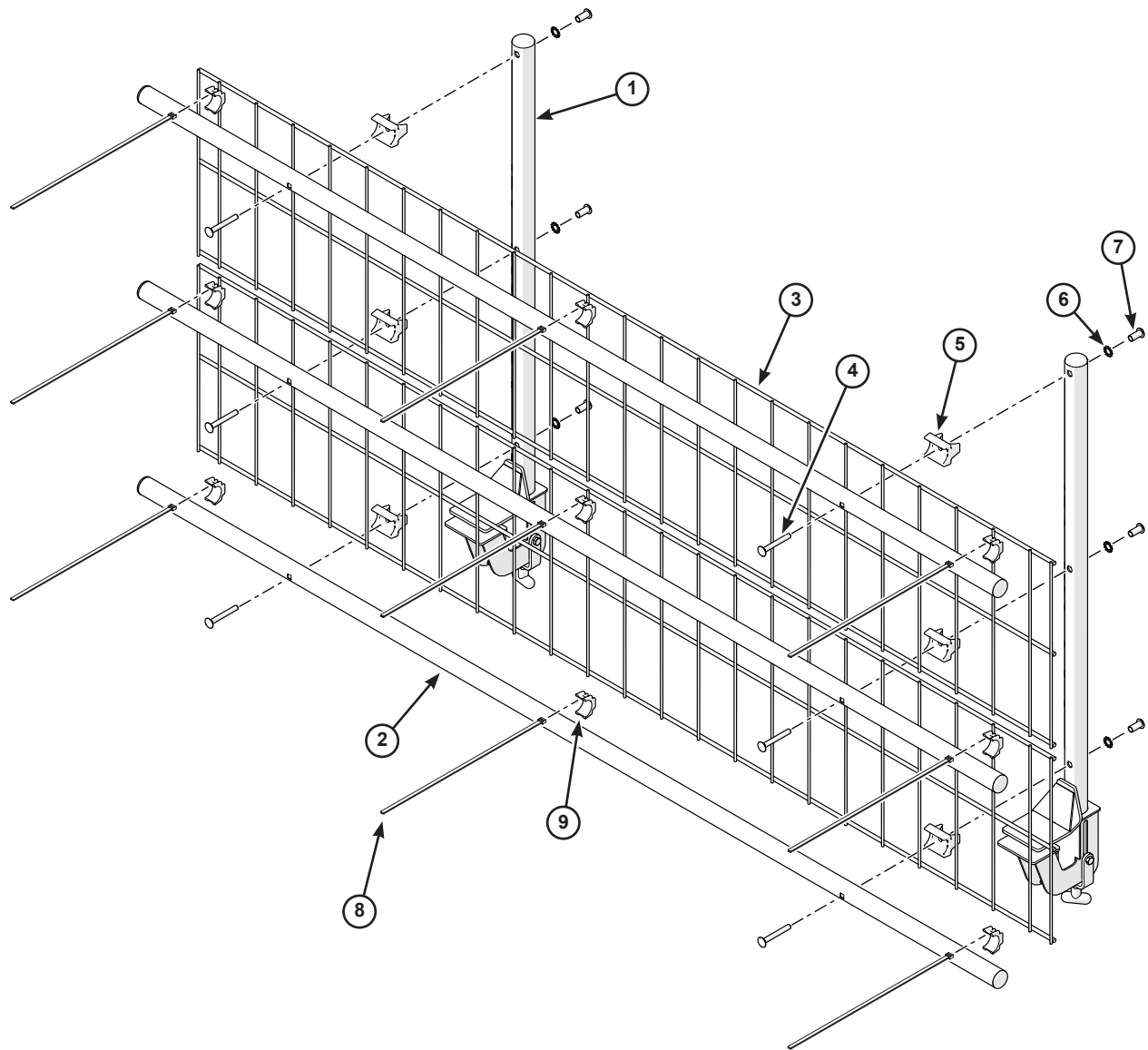

Item	Description	Item	Description
1	Upright Weldment	6	Toothed Lock Washer, 1/2" ID
2	Rail	7	Cap Nut, 3/8-16
3	Infill Panel	8	Nylon Tie
4	Carriage Bolt, 3/8-16 x 3"	9	Spacer
5	Tube Saddle		